

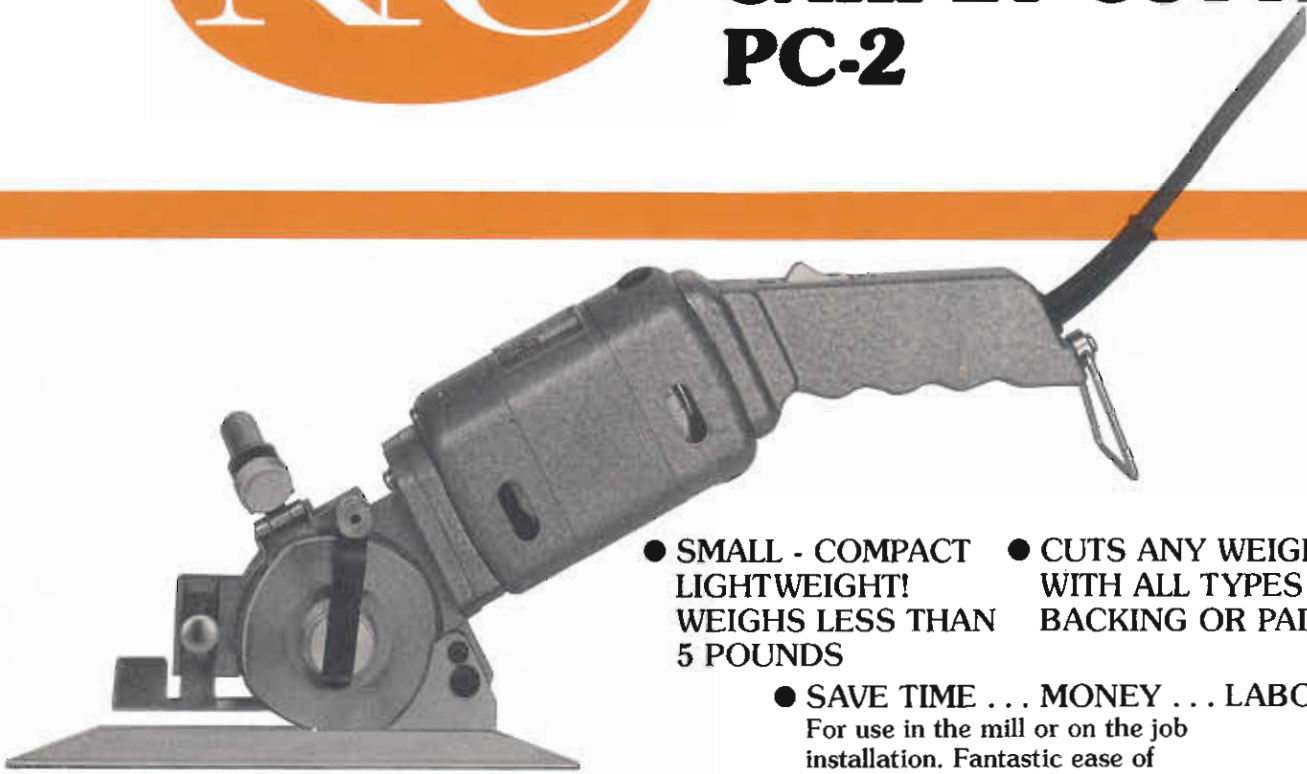

PORTABLE CARPET CUTTER PC-2



- SMALL - COMPACT LIGHTWEIGHT!
WEIGHS LESS THAN 5 POUNDS
- CUTS ANY WEIGHT CARPET WITH ALL TYPES OF BACKING OR PADDING
- SAVE TIME . . . MONEY . . . LABOR!
For use in the mill or on the job installation. Fantastic ease of handling. Cuts straight or slight curves . . . quickly . . . accurately.

HEAVY DUTY • SELF-SHARPENER • REMOVABLE BASE PLATE

IDEAL FOR USE ON FLOOR - TABLE TOP - OR RIGHT ON CARPET RACKS

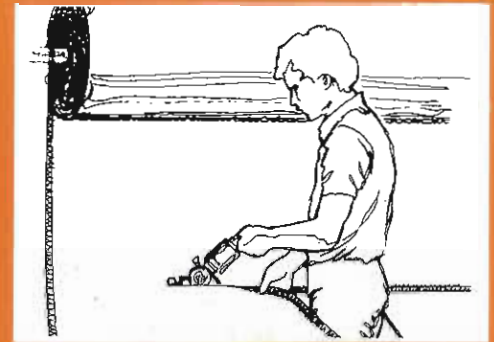
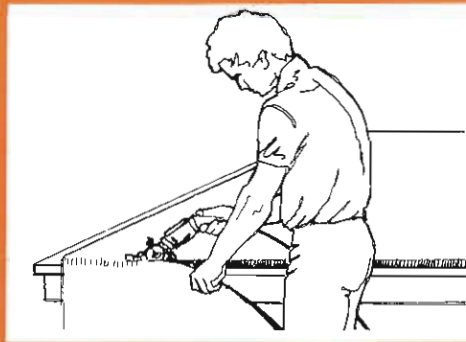

- Die cast motor housing
- Finger grip die cast handle
- Lightweight (approx. 5 lbs.)

- Heavy duty motor
- Automatic sharpener
- Fingertip on-off switch
- Tilt for angle cutting

- Removable base plate for cutting close to wall
- Adjustable pile guide

Portable Cutter comes complete with extra blade, sharpening stone, lint brush and tube of lubricant.



N-C CARPET BINDING & EQUIPMENT CORP.

73 WINTHROP ST., NEWARK, N J 07104 •PHONE (201) 481-3500



PORTABLE CARPET CUTTER PC-2

Parts List

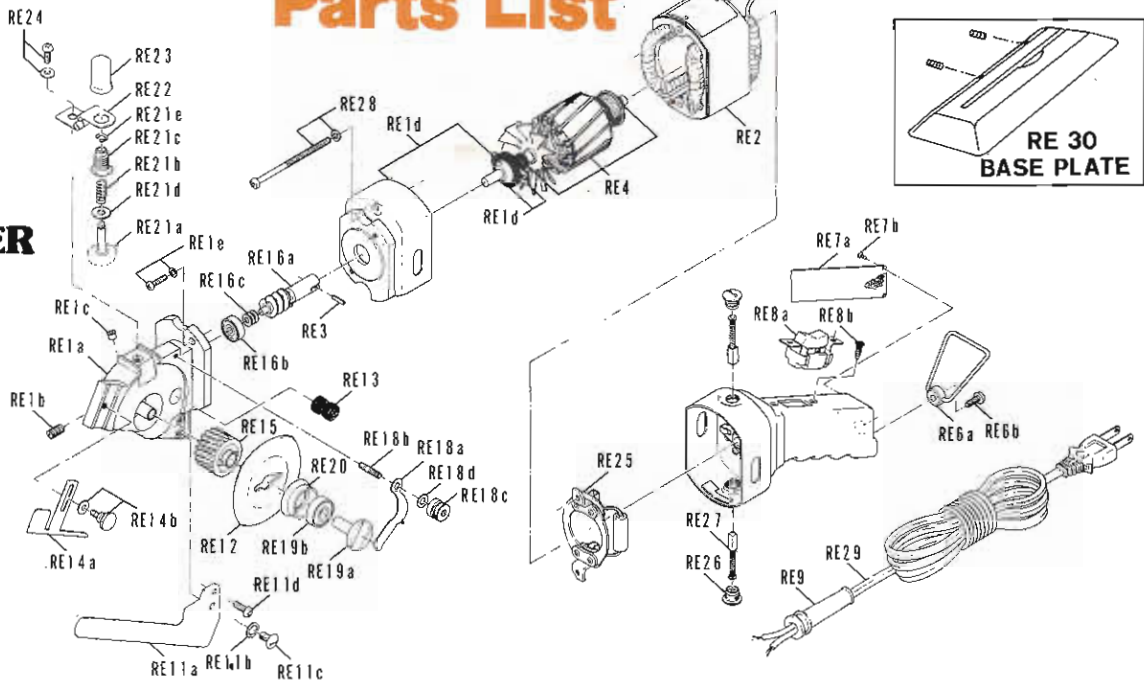

Part No.	Part Name	Q'ty
RE1	Gear box with motor front cover assembly . . .	1 set
RE1a	Gear box	1 pc.
RE1b	Screw	1 pc.
RE1c	Bushing	1 pc.
RE1d	Motor front cover	1 pc.
RE1e	Screw & washer	2 set
RE2	Stator	1 pc.
RE3	Pin	1 pc.
RE4	Rotor assembly	1 set
RE5	Motor rear cover with handle	1 set
RE6	Stand (hanger) assembly	1 set
RE6a	Stand (hanger)	1 pc.
RE6b	Screw	1 pc.
RE7a	Handle cover plate	1 pc.
RE7b	Screw	2 pcs.
RE8a	Switch	1 pc.
RE8b	Screw	2 pcs.
RE9	Cord rubber	1 pc.
RE11a	Lower knife (carbide tip)	1 pc.
RE11b	Washer	1 pc.
RE11c	Screw (large)	1 pc.
RE11d	Screw (small)	1 pc.
RE12	Upper rectangular blade	1 pc.
RE13	Felt	1 pc.
RE14a	Cloth guide	1 pc.
RE14b	Screw & washer	1 set
RE15	Gear	1 pc.
RE16a	Worm gear	1 pc.
RE16b	Bearing	1 pc.
RE16c	Wahser	3 pcs.
RE18a	Knife holder spring	1 pc.
RE18b	Screw	1 pc.
RE18c	Nut	1 pc.
RE18d	Washer	1 pc.
RE19a	Knife holder	1 pc.
RE19b	Bearing	1 pc.
RE20	Knife holder bushing	1 pc.
RE21a	Sharpening stone	1 pc.
RE21b	Spring	1 pc.
RE21c	Screw	1 pc.
RE21d	Washer	1 pc.
RE21e	E-ring	1 pc.
RE22	Grinder bracket	1 pc.
RE23	Grinder knob	1 pc.

Part No.	Part Name	Q'ty
RE24	Screw & washer	1 set
RE25	Carbon brush holder	1 pc.
RE26	Cap screw	2 pcs.
RE27	Carbon brush	2 pcs.
RE28	Screw & washer	2 sets
RE29	Electric cord with plug (10 feet)	1 pc.

Instructions

1. Handle the cutter with great care. Do not drop it or subject it to harsh impacts.
 2. Do NOT try to force the cutter through material.
 3. Never try to cut with a dull knife blade. When grinding the knife blade, do NOT force the blade against the grinding wheel.
- NOTE:** Before performing any work on the machine, be sure to unplug the machine.

4. To remove the knife, simultaneously lift the turned-up end of the knife retainer spring out of its groove in the knife hub and move it toward the motor. Then grasp the knife hub and remove it from the machine by pulling it out.

The knife can now be taken off.

When installing a new knife, be sure that its flat side is toward the body of the machine (bevelled side up), and that the two pins of the knife driver engage the slots at the center of the knife. Next replace the knife hub and return the knife retainer spring to its place in the hub groove.

5. Keep the machine clean by keeping the area around the knife free of lint and cuttings.
6. The machine requires a minimum of lubrication.

N-C CARPET BINDING & EQUIPMENT CORPORATION

**73 Winthrop Street
NEWARK, NEW JERSEY 07104**